

Global Protect VPN Client

[< Back to Our Technology](#) [< Back to Business Applications](#)

🕒 5-min read

What is Global Protect?

Global Protect is an app that allows you to create a tunnel to the campus network. It can allow you to browse library resources as if you are on campus, and should resolve most library access issues.



If you're having issues accessing a WSU resource when off campus, check to see if you're connected to VPN!

Table of Contents

- What is Global Protect?
- Install and Connect
- Disconnect
- Video Walkthrough
 - Windows
 - Mac
- Download PDF instructions
- Read On

Install and Connect

Windows

MacOS

iPad



James Henderson
Education Technology Analyst

Install

1. Download the GlobalProtect app from the App Store.

Connect

2. When using the app for the first time, you'll need to enter in the portal address: **spokane.wsu.edu**

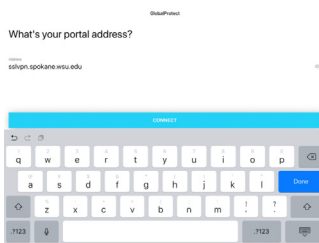

3. Tap **Connect**, then **allow** the app to add VPN configurations when prompted.
 - Occasionally, the app will freeze when creating the connection for the first time. If the app is still not responding after 30 seconds, force-close the app and reopen it.
4. Log in with your **WSU network ID** and **password**. You will be required to sign in every time you wish to connect to the VPN, and will need to complete the MFA process.

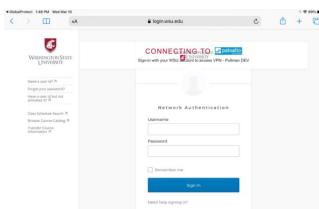

5. Tap **Sign In**. You are now connected to the WSU Spokane network via VPN. You can use your web browser apps as you normally would.

While connected, you should see your connection in top bar next to your wifi connection (shown here). You will also have a VPN option in your settings now.

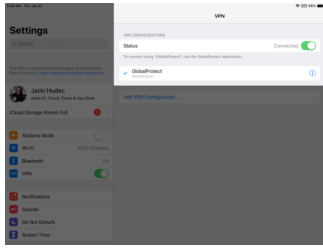

Disconnect

Open the Global Protect application on your device and select the **Disconnect** button.

